

**PRIDEMAXX**  
WOOD CABINETRY



# CUSTOM CABINET CONSTRUCTION

**SIDES:** 3/4" PLYWOOD WITH WHITE BIRCH VENEER. THE FRONT EDGES WILL BE EDGE BANDED WITH WOOD VENEER STAINED TO MATCH THE DOOR OF THE CABINETS. PERMANENT JOINTS ARE DOWELED, GLUED AND POCKET SCREWED.

**BACKS:** 1/4" MATCHING CABINET BACKS ARE DADOED INTO THE SIDES, FOR EXTRA RIGIDITY.

**NAILERS:** THREE 3/4" x 2-3/4" PLYWOOD NAILERS ARE SECURED TO BASE CABINETS, TWO ON THE TOP— AND ONE ON THE BACK. THERE ARE TWO 3/4" x 2-3/4" PLYWOOD NAILERS FOR WALL CABINETS AT THE BACK OF THE BOX.

**DRAWER BOXES:** 5/8" SOLID BIRCH DOVETAILED DRAWER BOX WITH TANDEM UNDERMOUNT, FULL-EXTENSION SOFT CLOSE GLIDE.

**SHELVES:** SHELVES ARE 3/4" THICK MAPLE MELAMINE WITH FRONT EDGE BANDED TO MATCH.

**TOPS & BOTTOMS:** SHELVES ARE 3/4" THICK MAPLE MELAMINE



# Order Detail

Customer Name \_\_\_\_\_

Bill to: \_\_\_\_\_

\_\_\_\_\_

\_\_\_\_\_

Phone: \_\_\_\_\_ Fax: \_\_\_\_\_

Email \_\_\_\_\_

Ship to: \_\_\_\_\_

\_\_\_\_\_

\_\_\_\_\_

Phone: \_\_\_\_\_ Fax \_\_\_\_\_

Contact: \_\_\_\_\_

Email: \_\_\_\_\_

- \_\_\_\_\_ North Hill Maple    \_\_\_\_\_ Claremont    \_\_\_\_\_ Capri
- \_\_\_\_\_ North Hill Toffee    \_\_\_\_\_ Heritage Oak    \_\_\_\_\_ Roma
- \_\_\_\_\_ Tuscany    \_\_\_\_\_ Cambridge    \_\_\_\_\_ Ebony
- \_\_\_\_\_ Madison    \_\_\_\_\_ Fairmont    \_\_\_\_\_ Zebrano

- Assembled \_\_\_\_\_    Base—\$15.00
- Not Assembled \_\_\_\_\_    Wall—\$10.00
- \_\_\_\_\_    Tall— \$25.00

Date \_\_\_\_\_

Item #	Qty	Cabinet Name	Hinge	Fin End
1				
2				
3				
4				
5				
6				
7				
8				
9				
10				
11				

Item #	Qty.	Cabinet Name	Hinge	Fin End
12				
13				
14				
15				
16				
17				
18				
19				
20				
21				
22				

# CABINET CROSS SECTION-CUSTOM

## BASE CABINET

FAIRMONT, CAMBRIDGE, ZEBRANO, EBONY, ROMA, CAPRI

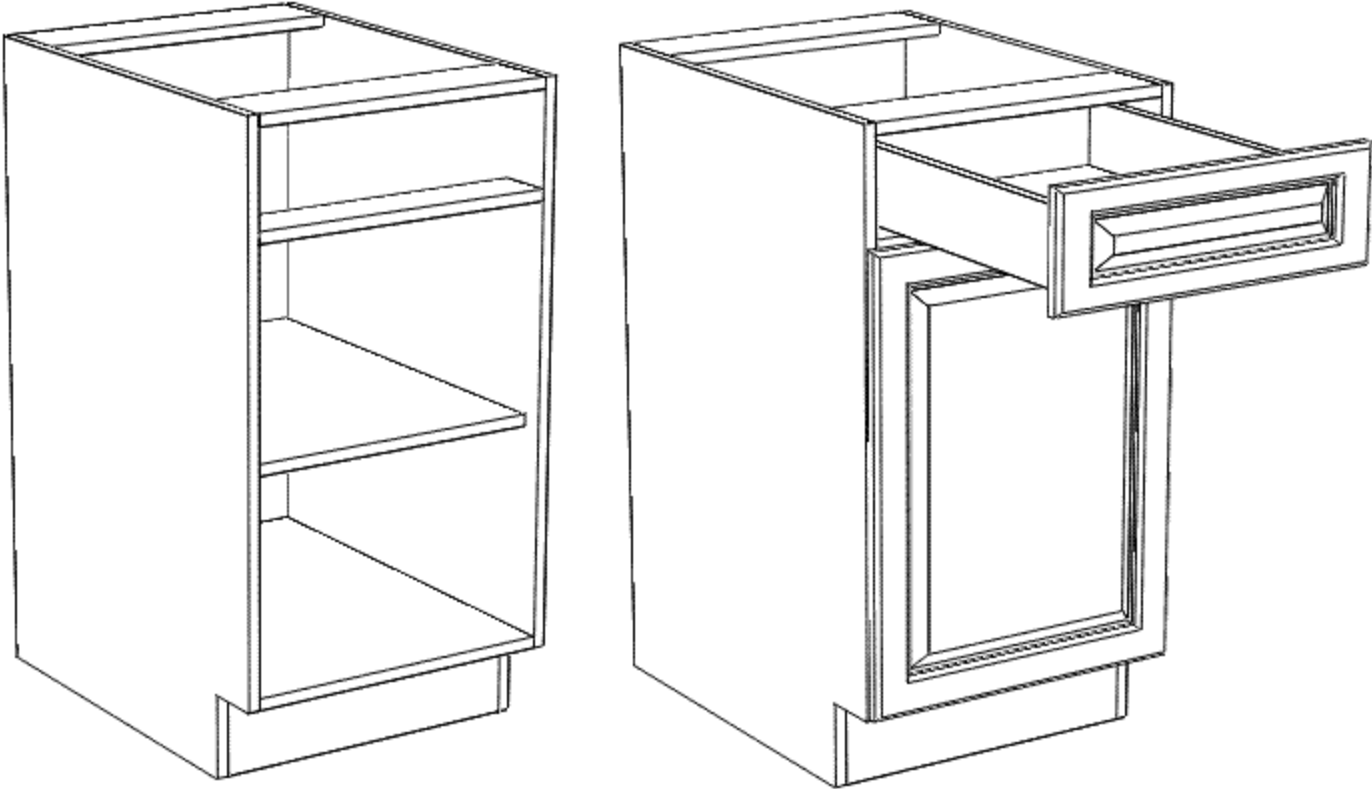

- FRAMELESS CABINET
- 3/4" PLYWOOD SIDES
- 34 1/2" CABINET HEIGHT
- 21" DRAWER BOX
- FULL DEPTH ADJUSTABLE SHELF
- 4 1/2" TOE KICK HEIGHT

# CABINET CROSS SECTION-CUSTOM

## WALL CABINET

FAIRMONT, CAMBRIDGE, ZEBRANO, EBONY, ROMA, CAPRI

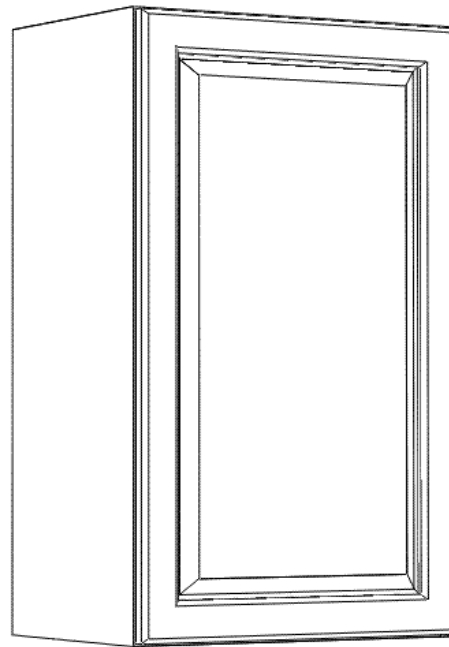
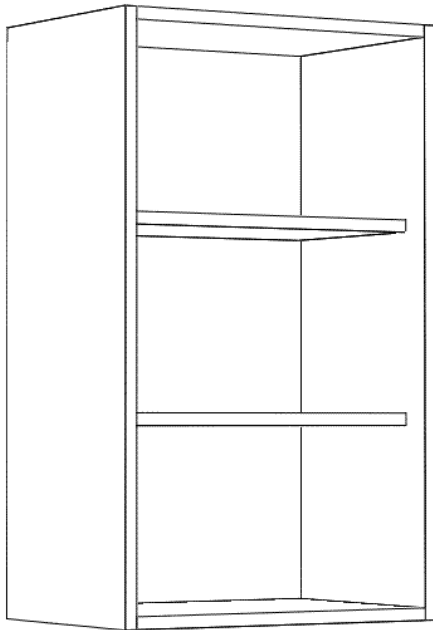

- FRAMELESS CABINET
- 3/4" PLYWOOD SIDES
- 12" CABINET DEPTH
- ADJUSTABLE SHELVES
- AVAILABLE CABINET HEIGHTS  
12,15,18,24,30,42

# CABINET CROSS SECTION-CUSTOM

## TALL CABINET

FAIRMONT, CAMBRIDGE, ZEBRANO, EBONY, ROMA, CAPRI

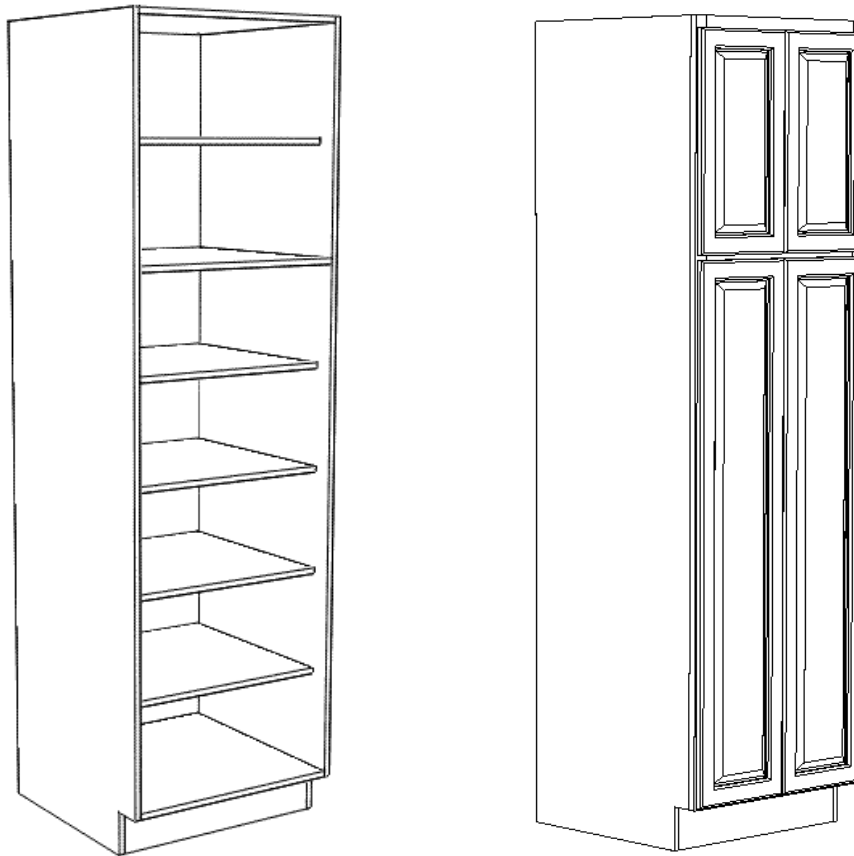

- FRAMELESS CABINET
- 3/4" PLYWOOD SIDES
- FULL DEPTH DEEP ADJUSTABLE SHELVES
- 26" CABINET DEPTH
- SHIPPED WITH DETACHED TOE KICK FOR EASY INSTALL
- STANDARD CABINET WIDTHS  
12,15,18,24,30,36

# THE CAMBRIDGE

CHERRY FINISH SHAKER  
3" STYLE & RAIL

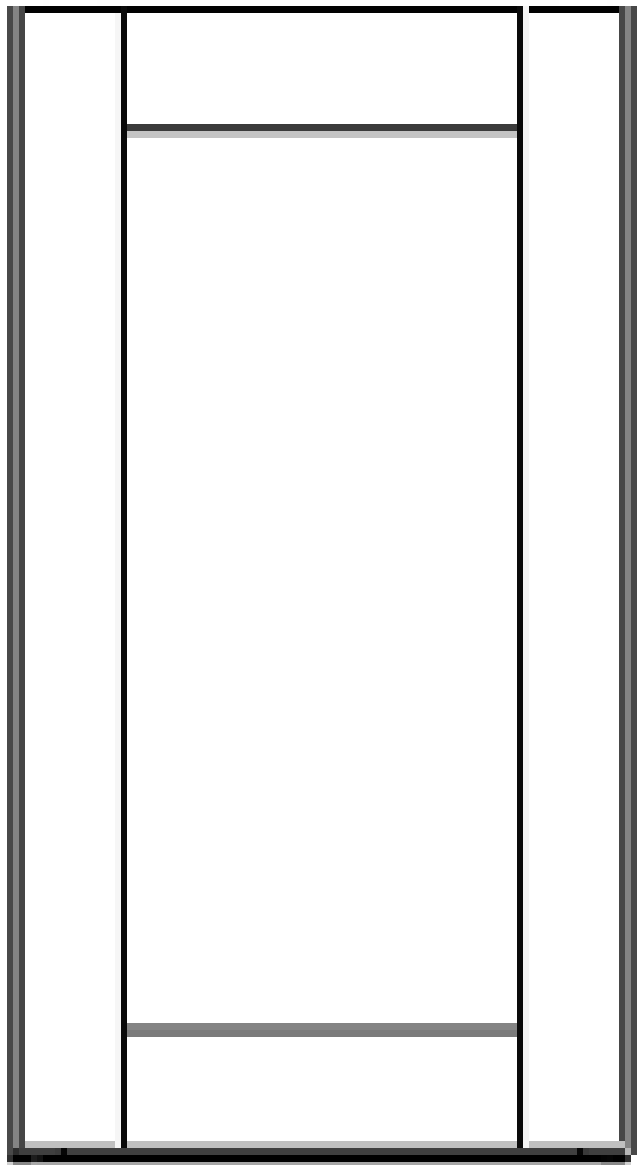

# THE FAIRMONT

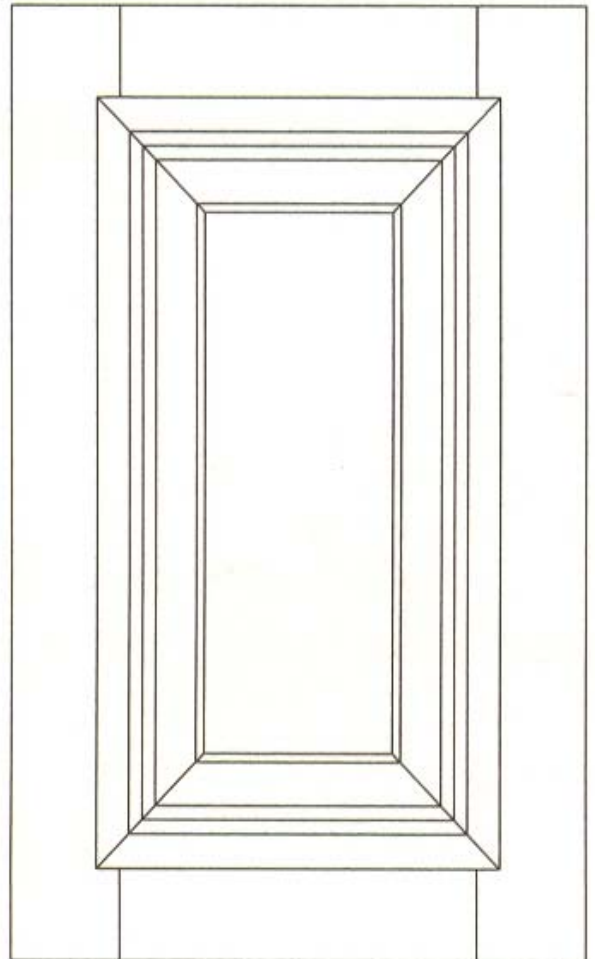
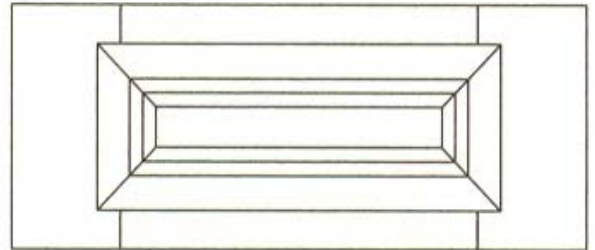

# THE ROMA ITALIAN DECORATIVE VENEER

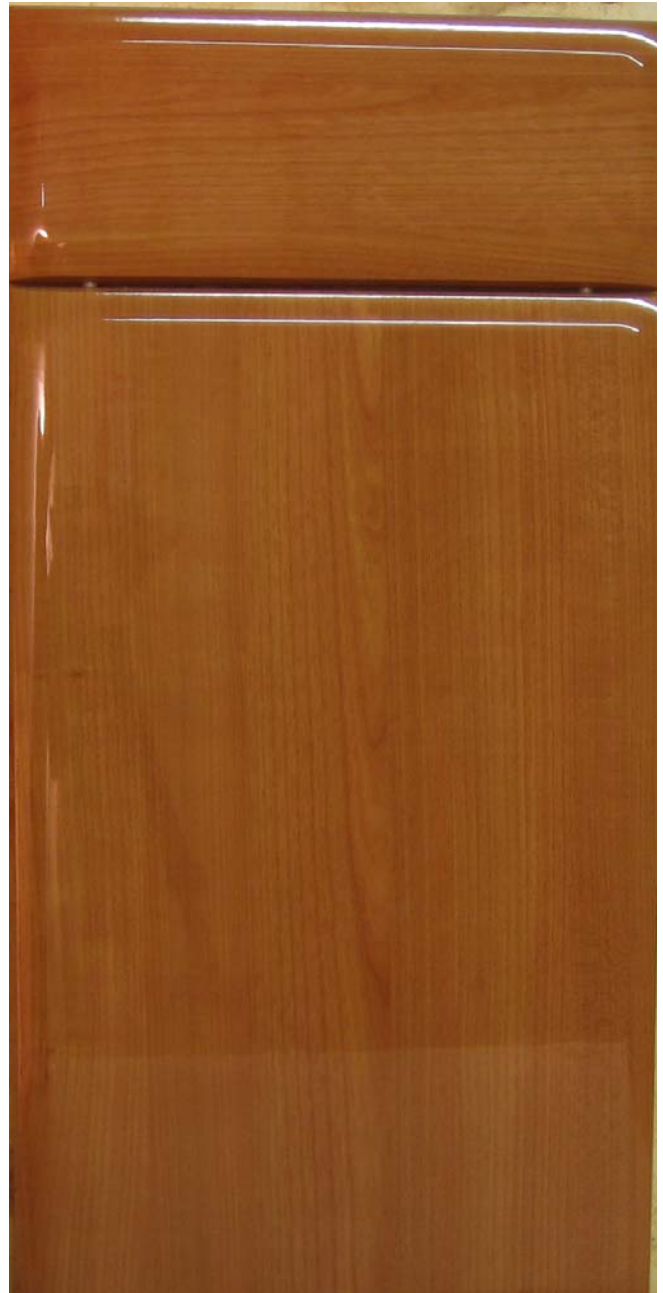

## THE ZEBRANO



## THE EBONY

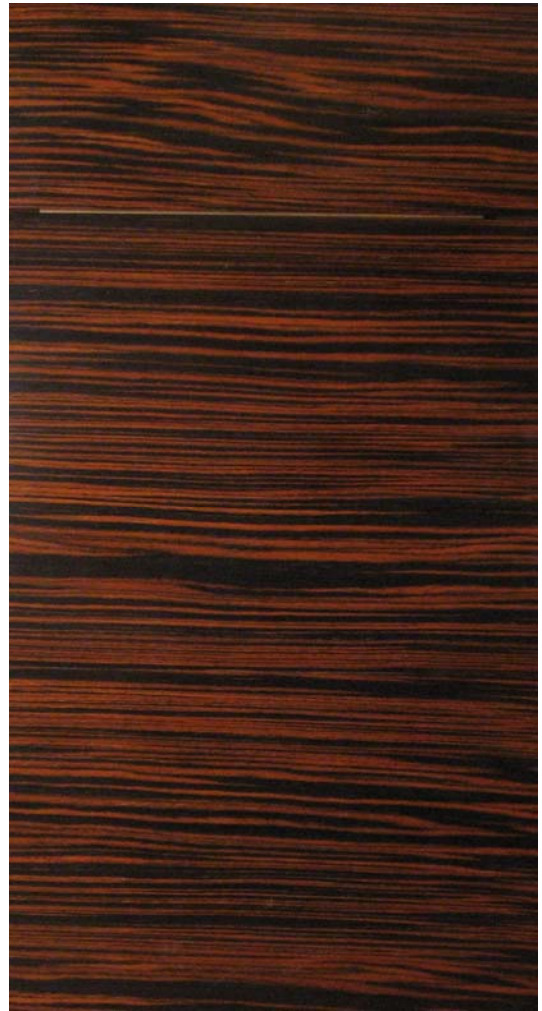

EUROPEAN SLAB STYLE DOOR

# THE CAPRI ITALIAN DECORATIVE VENEER

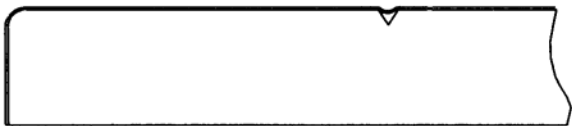
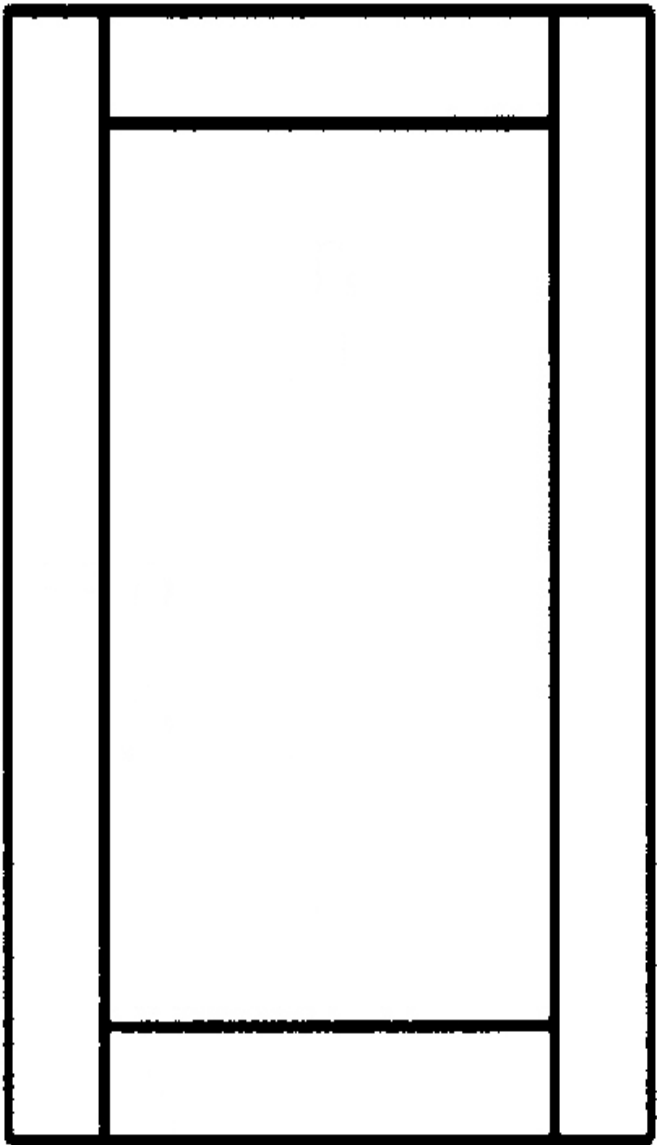
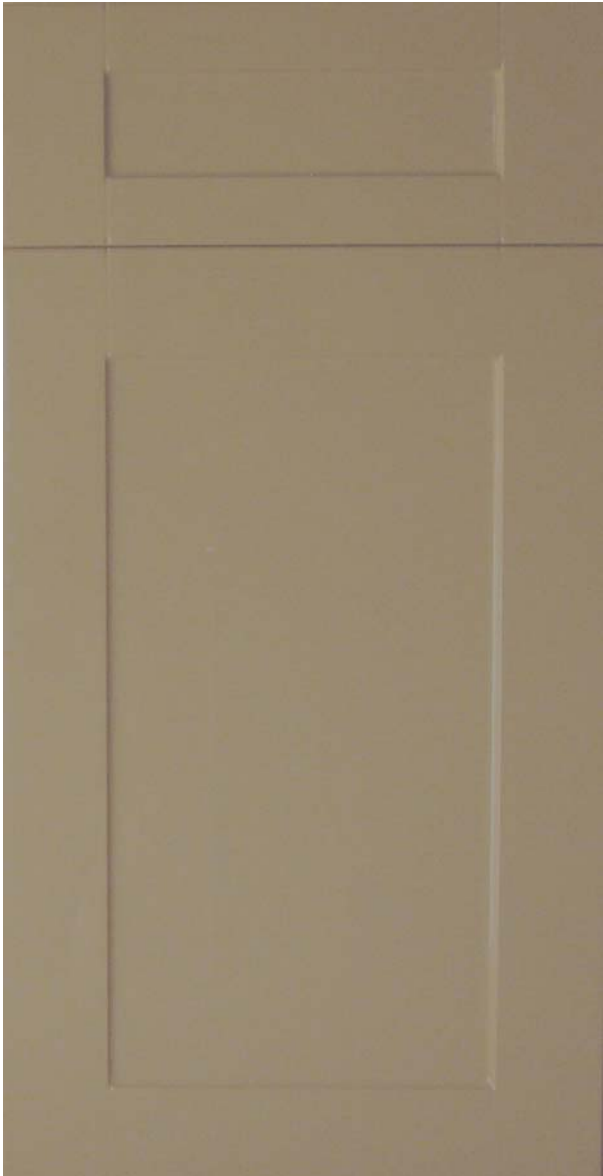

## WALL CABINETS

DOUBLE DOOR  
12" DEEP

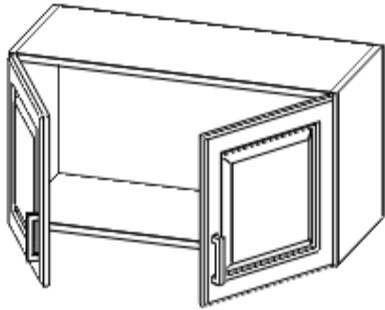

W3012
W3312
W3612
W3015
W3315
W3615
W3018
W3318
W3618
W3024
W3624

DOUBLE DOOR  
24" DEEP

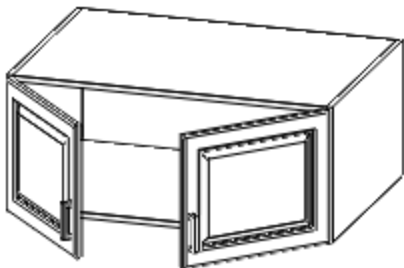

W3612-24
W3615-24
W3618-24
W3624-24

# WALL CABINETS

## SINGLE DOOR 30" AND 36" HEIGHTS

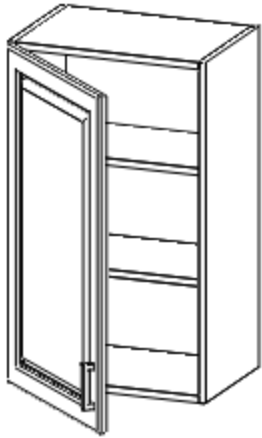

W0930
W1230
W13.530
W1530
W16.530
W1830
W2130
W2430-S
W0936
W1236
W13.536
W1536
W16.536
W1836
W2136

## SINGLE DOOR

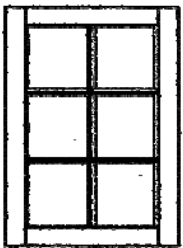

6L = SIX



L = SINGLE

W1230-6L
W1230-L
W1530-6L
W1530-L
W1830-6L
W1830-L
W2430-6L
W2430-L
W1236-6L
W1236-L
W1536-6L
W1536-L
W1836-6L
W1836-L
W2436-6L
W2436-L

# WALL CABINETS



## DOUBLE DOOR WALL CABINETS 30" & 36"

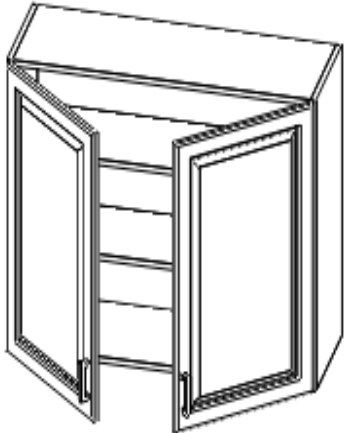

W2430
W2730
W3030
W3330
W3630
W4230
W4830
W2436
W2736
W3036
W3336
W3636
W4236

## DOUBLE DOOR WITH GLASS

30" & 36"



6L = SIX LITES L=SINGLE LITE

W2430-6L
W2430-L
W3030-6L
W3030-L
W3630-6L
W3630-L
W2436-6L
W2436-L
W3036-6L
W3036-L
W3636-6L
W3636-L

CABINET DOES NOT INCLUDE GLASS.

WALL CABINETS

CORNER WALL

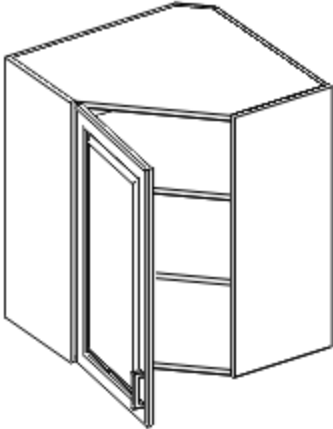

WDC 2430
WDC 2436
WDC2736-15
WDC 2742-15

CORNER WALL WITH GLASS MULLION DOOR

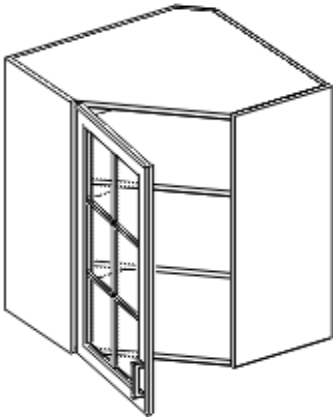

WDC2430-MD
WDC2436-MD
WDC2736-15-MD
WDC2742-15-MD

BLIND WALL CABINETS

CABINET DOES NOT INCLUDE GLASS.

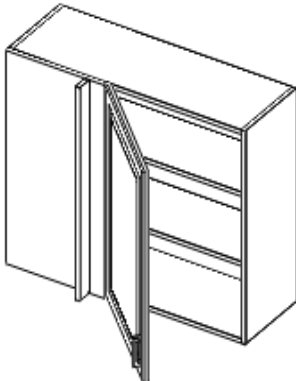

WBC3030
WBC3630
WBC3036
WBC3636

WALL CABINETS

MICROWAVE CABINET  
HEIGHT: 30" & 36"

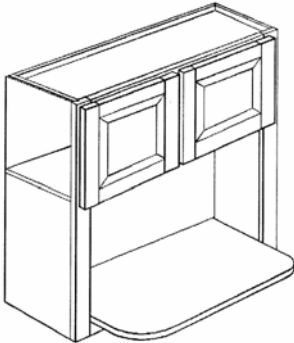

MW3030  
MW3036

WALL END CABINET

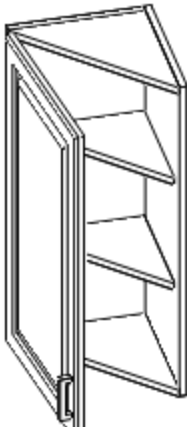

WEC1230  
WEC1236

OPEN END SHELF  
HEIGHT: 30" AND 36"

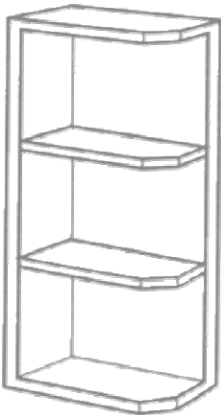

W0ES630  
W0ES636

End shelves to be angled on top and bottom for molding.

## ACCESSORIES & OTHER

OPEN PLATE RACK  
HEIGHT: 15 "

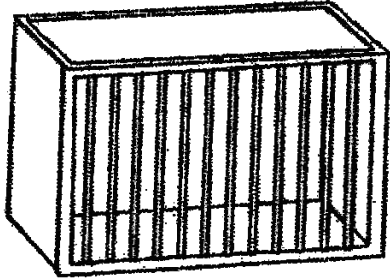

WPR-3615

CABINET WILL BE 15 3/8" HIGH TO ENSURE WALL CABINETS TO LINE UP.

WINE RACK  
HEIGHT: 18 "

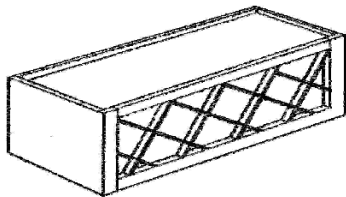

WR3018

CABINET WILL BE 18 3/8" HIGH TO ENSURE WALL CABINETS TO LINE UP.

WINE GLASS HOLDER

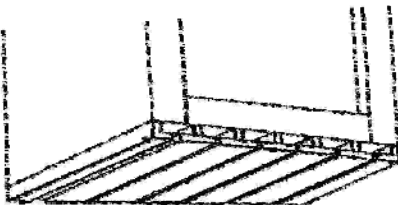

WGH 30

FULL HEIGHT BASE

FULL HEIGHT  
BASE CABINET  
SINGLE DOOR

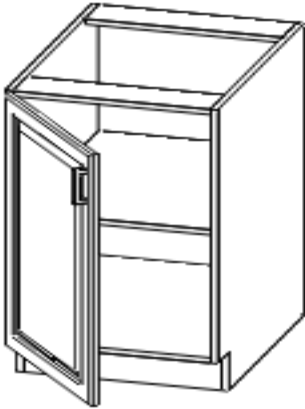

FHB-09
FHB-12
FHB-13.5
FHB-15
FHB-16.5
FHB-18
FHB-21
FHB-24-S

FULL HEIGHT  
BASE CABINET  
DOUBLE DOOR

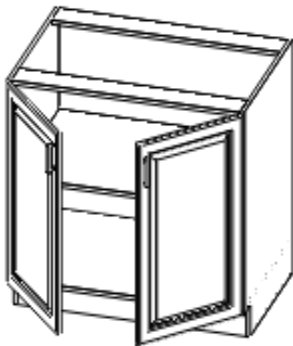

FHB-24
FHB-27
FHB-30
FHB-33
FHB-36
FHB-42
FHB-48

## BASE CABINETS

### BASE CABINET 1 DOOR, 1 DRAWER



- B12
- B15
- B18
- B21
- B24-S

### BASE CABINET



- B24
- B27
- B30
- B33
- B36

### BASE CABINET 2 DOOR, 2 DRAWER

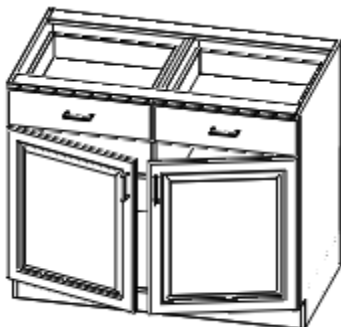

- B42
- B48

CABINET WILL HAVE (2) DOORS AND (2) FALSE FRONTS FOR SINK

BASE CABINETS

DRAWER BASE UNITS

3 DRAWERS UNITS



- DB12-3
- DB15-3
- DB18-3
- DB21-3
- DB24-3
- DB30-3
- DB33-3
- DB36-3

4 DRAWERS UNITS

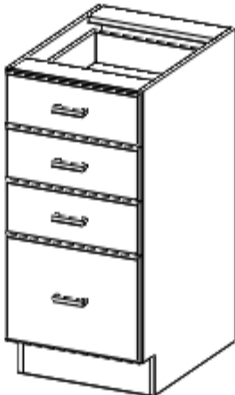

- DB15-4
- DB18-4
- DB21-4

# BASE CABINETS

## SINK BASE CABINETS

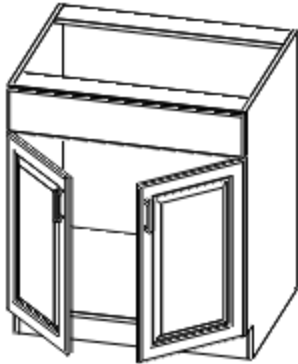

SB18*
SB21*
SB24*
SB24
SB27
SB30
SB36
SB42**
SB48**

\* SINK BASE WILL HAVE (1) DOOR AND (1) FALSE FRONT

\*\* SINK BASE WILL HAVE (2) DOORS AND (2) FALSE FRONTS

## ANGLED SINK BASE

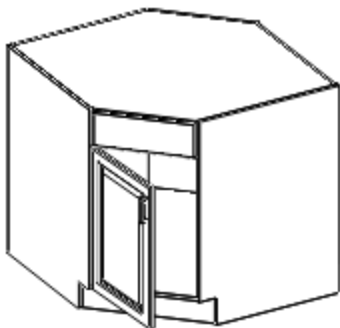

DCSB36
--------

## BASE CABINETS

### LAZY SUSAN BASE CABINET

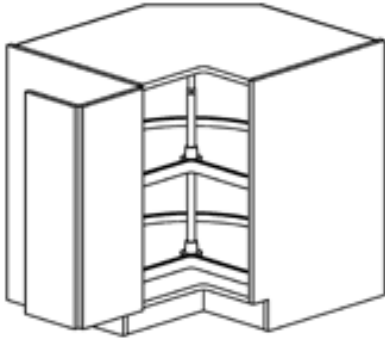

**BLS36**  
**EZR36**

### BLIND BASE CABINET 1 DOOR 1 DRAWER

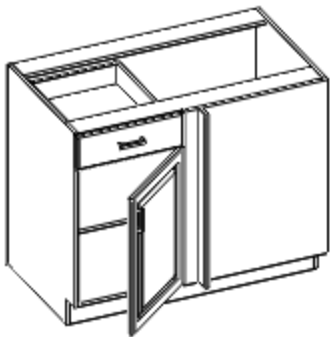

**BBC 39**  
**BBC 42**  
**BBC 48**

### BASE OPEN SHELF CABINET

WIDTH: 24"  
DEPTH: 12"

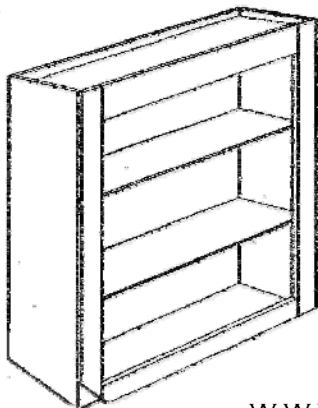

**BOES-12**

## BASE CABINETS

### DRAWER BASE UNITS

#### BASE END ANGLE

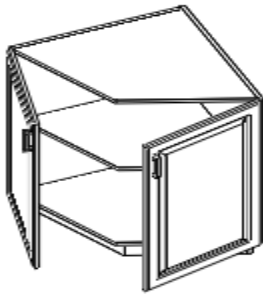

BEC24

### PENCIL DRAWER

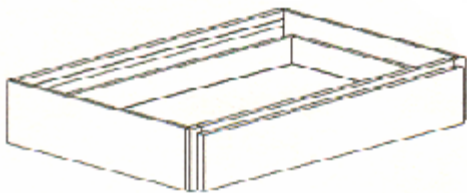

PD30

PD36

# TALL CABINETS

SINGLE PANTRY  
HEIGHT: 84" AND 90"  
DEPTH: 26"

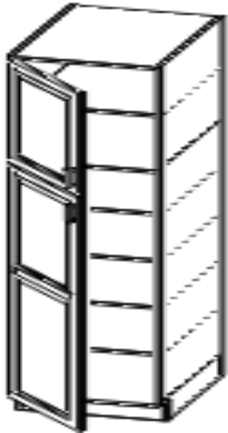

UC1284-26
UC1290-26
UC1584-26
UC1590-26
UC1884-26
UC1890-26

DOUBLE PANTRY  
HEIGHT: 84" & 90"  
DEPTH: 26"

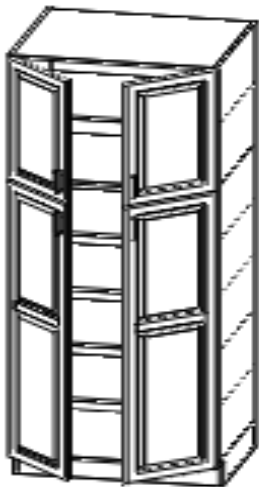

UC2484-26
UC2490-26
UC3084-26
UC3090-26
UC3684-26
UC3690-26

TALL CABINETS

OVEN CABINET

HEIGHT: 84" & 90", 2 DOORS,  
1 DRAWER

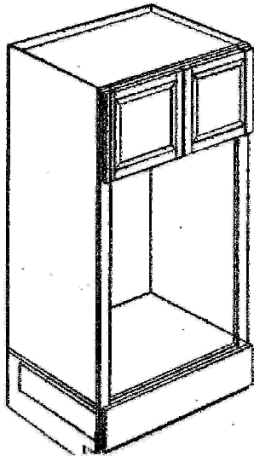

- OVS3084-26
- OVS3090-26
- OVS3384-26
- OVS3390-26

OVEN CABINET

HEIGHT: 84" & 90", 2 DOORS,

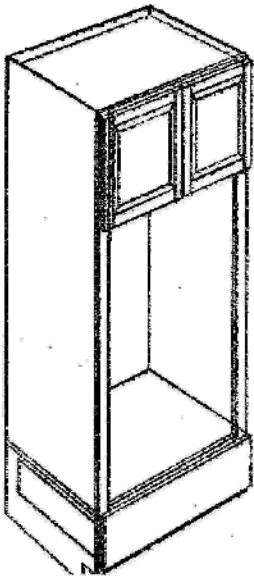

- OVD3084-26
- OVD3384-26
- OVD3090-26
- OVD3390-26

# VANITY BASE CABINETS



## VANITY SINK CABINET

HEIGHT: 34 1/2"

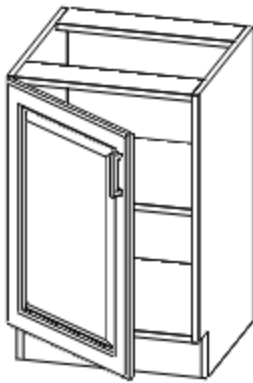

VS1816

## VANITY SINK CABINET

2 DOORS DEPTH:21" HEIGHT:

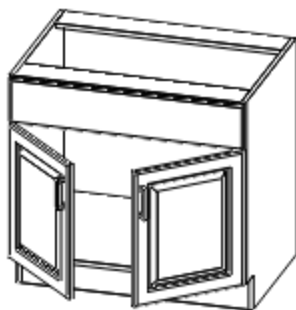

VSB2421  
VSB3021  
VSB3621

## VANITY DRAWER BASES CABINETS

### VANITY DRAWER CABINET HEIGHT 34 1/2"



- VDB 12BH
- VDB 15BH
- VDB 18BH

### VANITY SINK & DRAWER CABINET HEIGHT 34 1/2"



- VSD2421
- VSD3021
- VSD3621

ALL CABINETS WILL HAVE (2) WORKING DRAWERS AND (1) FALSE FRONT

### VANITYSINK DRAWER CABINET HEIGHT 34 1/2"

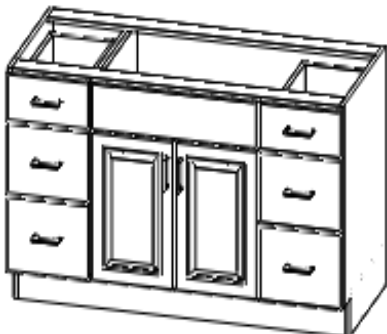

- VS48BH

CABINET WILL BE STANDARD WITH (2) DOORS AND (6) DRAWERS.

# ACCESSORIES & OTHER

## ROLL OUT TRAY

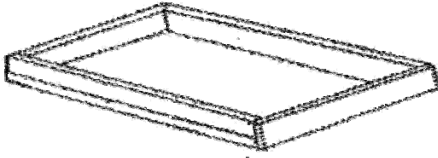

RT-15
RT-18
RT-21
RT-24

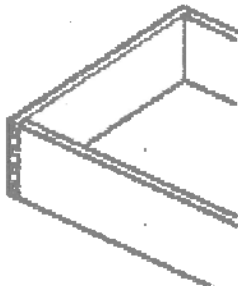

PRIDEMAX ROLL-OUT TRAYS ARE THE SAME HIGH QUALITY DRAWER BOX USED IN EVERY BASE CABINET.

## GLASS DOORS

“DOOR ONLY”



L= SINGLE LITE

1230-SL
1530-SL
1830-SL
1236-SL
1536-SL
1836-SL

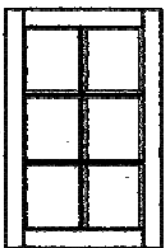

6L = SIX LITES

1230-6L
1530-6L
1830-6L
1236-6L
1536-6L
1836-6L

GLASS WILL NOT BE INCLUDED WITH GLASS DOOR.

# ACCESSORIES & OTHER

## END PANELS

### BASE END PANELS

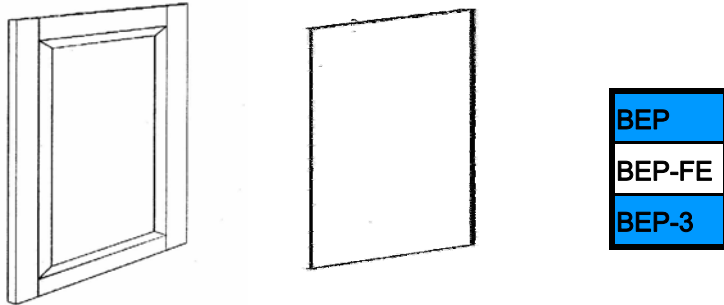

BEP DECO DOOR END FOR BASE CABINET  
BEP-FE FINISHED END FOR BASE CABINET

### WALL END PANEL

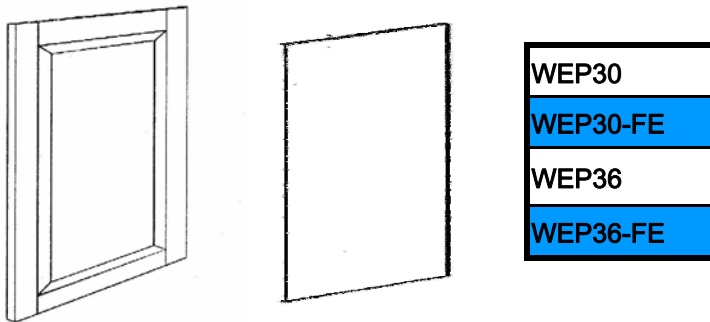

WEP DECO DOOR END FOR WALL CABINET  
WEP-FE FINISHED END WALL CABINET

### TALL END PANEL

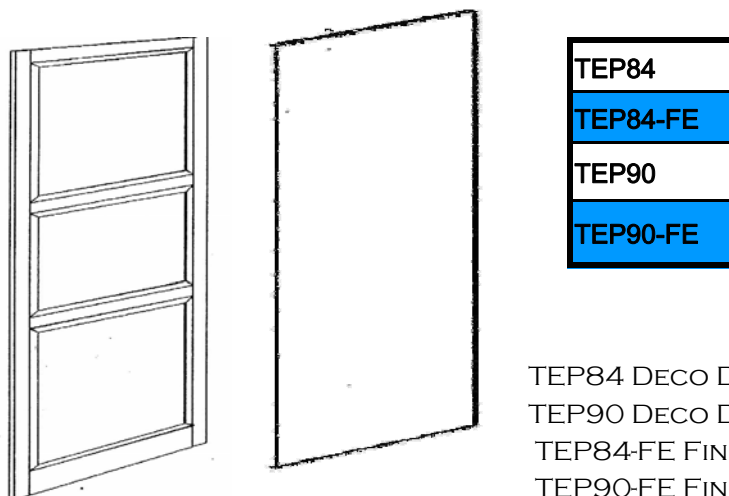

TEP84 DECO DOOR END FOR 84" CABINET  
TEP90 DECO DOOR END FOR 90" CABINET  
TEP84-FE FINISHED END FOR 84" CABINET  
TEP90-FE FINISHED END FOR 90" CABINET

ACCESSORIES & OTHER

REFRIGERATOR PANELS

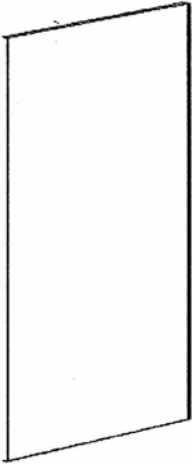

REP-2684
REP-2690
REP3-2684
REP3-2690

REP3 - 3" FILLER ATTACHED TO PANEL.

FINISHED BACK PANELS

96" x 48" x 3/4"

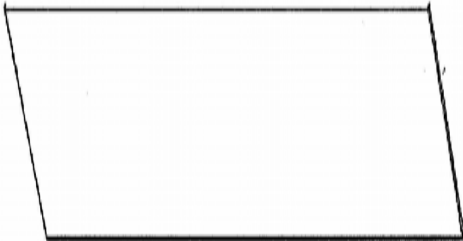

BP34
BP1/4 "

FINISHED TOE KICK

96" x 4 1/2" x 3/4"



TK8
-----

ACCESSORIES & OTHER

LEGS: REEDED

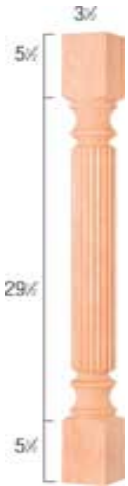

ISLAND LEG-  
REEDED

STN-REED 3 1/2" W x 35 1/4" H Call for pricing on 4 1/2" leg

\*\* Veneered Style doors will have solid painted legs

LEGS: CLASSIC

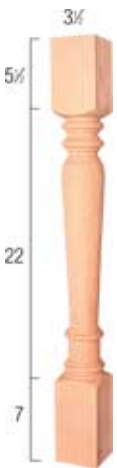

ISLAND LEG-  
CLASSIC

-CLASSIC 3 1/2" W x 35 1/4" H

\*\* Veneered Style doors will have solid painted legs

TOE KICK CORNER

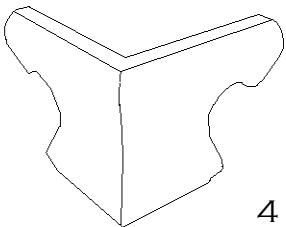

TKC

4 1/2"

\*\* Veneered Style doors will have solid painted legs

# ACCESSORIES & OTHER

## MILLWORK AND MOULDING



LIGHT

CRM-L

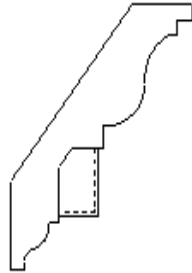

CRM

CRM
CRM-L
OSC-8
ISC-8
Rope-8
Dentil-8

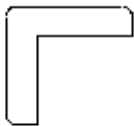

OSC-8



ISC-8

CRM-L - 4 1/2" HIGH    CRM - CROWN W/ DENTIL/ROPE  
OSC-8 - 3/4" x 3/4"    ISC-8 - 3/4" x 3/4"

## FILLERS



FLUTE  
D



PLAIN  
FILLER

BF3
BF6
WF3-42
WF6-42
TF3-96
TF6-96
WFF3-42
TFF3-96

FLUTED FILLERS WILL NEED TO BE CUT DOWN ON JOB SITE TO FIT LAYOUT.